



STORM MEDIUM PLASTER RING

DATA

Collection	STORM SYSTEM® MEDIUM
Product	Storm Medium Plaster Ring
Article no.	1A01.0001.01

SPECIFICATIONS

Weight	60 g
Material	ABS
Overall dimensions	Ø147 mm, H:36 mm
Labelling	CE
Load	5 kg (see step 2)

OPTIONAL ACCESSORIES

Storm Medium	
Extension Basic	1A01.0015.xx.yy
Storm Medium Front Ring	1A01.0018.xx
Storm Medium Cabinet	1A01.0056.01

NOTE

An installation ring for plasterboard, wooden, and acoustic ceilings. The plaster ring is designed to hold all products in the STORM SYSTEM® MEDIUM collection.

If installing Storm Output, please be aware of the chosen pendant's static load. The anchoring of Storm Plaster Ring / ceiling must be carried out so that it corresponds with the chosen pendant's load.

STORM SYSTEM®

The Storm Medium Plaster Ring is part of the STORM SYSTEM® MEDIUM collection. A collection that includes a wide range of special designed products.

The STORM SYSTEM® collection is carefully designed to flush the surface of any ceiling or wall, and all products will appear with an absolute minimum of tolerance and visibility.

Storm Medium Plaster Ring is an installation ring for plasterboard and acoustic surfaces. To ensure the installation flushes the surface and appears with an absolute minimum of visibility the installation ring must be covered with filler. The Storm Medium Plaster Ring holds all products in the STORM SYSTEM® MEDIUM collection.

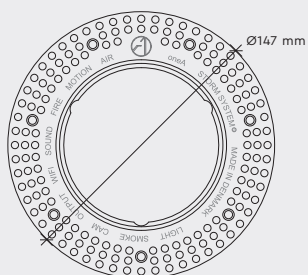
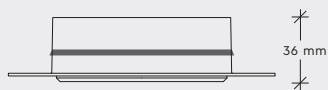

IMPORTANT INFORMATION

Installation and mounting must be performed by skilled personnel only, and instructions must be followed.

CLEANING AND MAINTENANCE:

Use a soft moist cloth for cleaning. No further maintenance is required.

WARRANTY:

If the product is defect, please contact your supplier immediately. Please note that warranty will not apply in case of wrongful use or if unskilled personnel attempts to repair.

COMPONENTS

- Storm Medium Plaster ring
- Foam plug

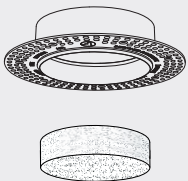

SUSPENSION

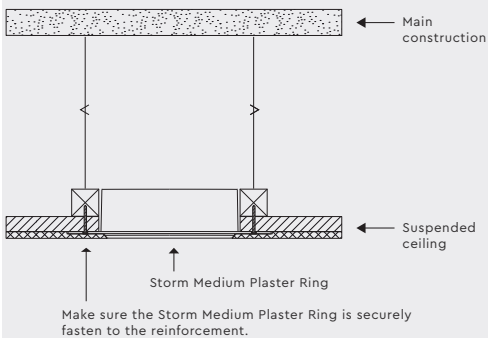

STORM MEDIUM PLASTER RING

ASSEMBLY INSTRUCTION

STEP 1

Cut a round hole with a diameter of 105 mm.

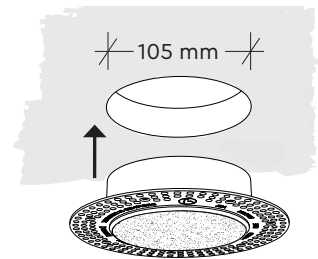

STEP 2

Place the plaster ring in the hole and securely fasten it with screws. Remove all burrs.

Make sure that there is an optimal base for a secure attachment. *See detail Attachment must obtain a static load of minimum 5kg.

Static load > 5kg:

If heavy load is required, ex. heavy pendants, the attachment must be anchored in the main construction above suspended ceiling.

NOTE It is the installer's responsibility to use the correct screws to ensure the optimal attachment

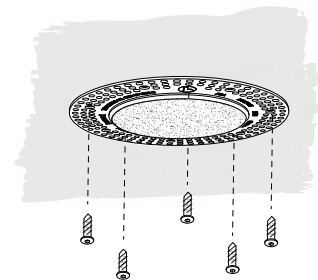

STEP 3

When plastering the ceiling, the foam plug should be placed inside the plaster ring. Exercise caution when plastering to prevent damage of the plastering.

BE AWARE: DO NOT TOUCH THE EDGE OF THE PLASTER RING WHEN SANDING!

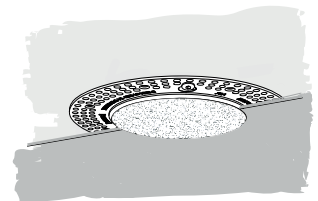

Screwfast surface

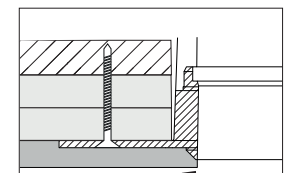
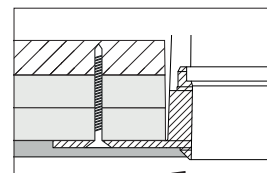
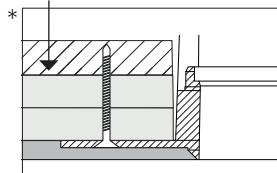

Plasterboard

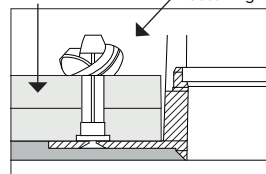

STEP 4

Remove the foam plug when the plastering is finished.

Please note that it is very important that the inside of the plaster ring is kept free of filler and paint. Any residue has to be removed. The plaster ring edge must not be damaged.

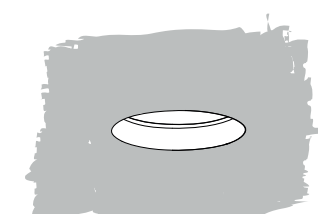

IMPORTANT INFORMATION

Installation and mounting must be performed by skilled personnel only, and instructions must be followed.

CLEANING AND MAINTENANCE:

Use a soft moist cloth for cleaning. No further maintenance is required.

WARRANTY:

If the product is defect, please contact your supplier immediately. Please note that warranty will not apply in case of wrongful use or if unskilled personnel attempts to repair.

COMPONENTS

- Storm Medium Plaster ring
- Foam plug



STORM MEDIUM PLASTER RING

ASSEMBLY INSTRUCTION

INSTALLATION OF DUCT PIPE – ONLY FOR AIR IN AND AIR OUT

Storm Medium Air In/Out is compatible with $\varnothing 100$ mm duct piping

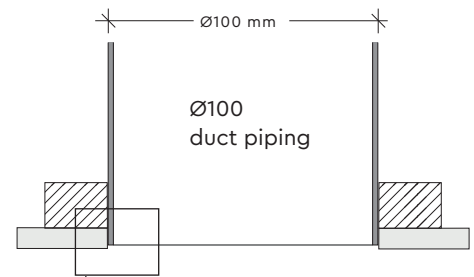

Make sure the ventilation ducts is positioned correctly. Then mount the Storm Plaster Ring according to the installation guide.

